

## Aluminum Marine Shapes

### 6061 - T6 Hull Stiffener

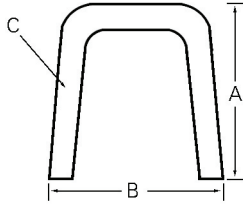

■ Stocked in 25 foot lengths

Height (A)	Width (B)	Thickness (C)	Lbs/Ft	Lbs/Length	Part Number
2	3	.188	1.300	32.500	230980

Dimensions are in inches. All weights are approximate.

### 6063 - T52 Extruded "G" Shape

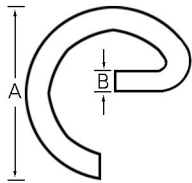

■ Stocked in 25 foot lengths

Size (A)	Thickness (C)	Lbs/Ft	Lbs/Length	Part Number
1 <sup>3</sup> / <sub>8</sub>	1/ <sub>8</sub>	.475	11.875	467715

Dimensions are in inches. All weights are approximate.

### 6061 - T6 Sch 40 Half Round Pipe and Tube

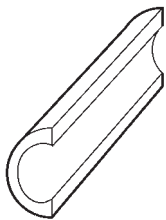

Nominal Pipe Size	Outside Diameter	Wall	Lbs/Ft	Lbs/Length	Part Number
2*	2.375	.154	0.645	16.130	593192
2 1/2*	2.875	.203	1.092	27.300	510851
3 1/2**	4.000	.190	1.184	23.680	476023

\* 25 Foot Half Round Pipe

\*\* 20 Foot Half Round Tube

Dimensions are in inches. All weights are approximate.