

Copper-Nickel Outlets

Outlets, Class 400

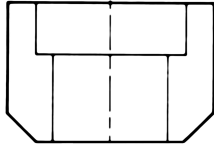

Socket Weld

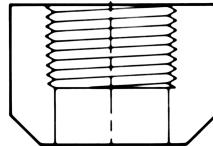

Threaded

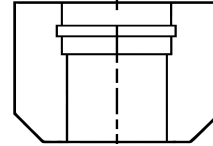

Brazed

Outlets, Class 3000

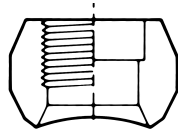

Threaded or
Socket Weld

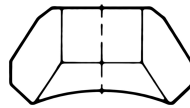

Buttwelding

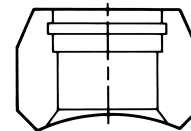

Brazed

- Weld base ground for full penetration weld per MIL-STD-22D (P68 joint)
- Conforms to the requirements of MSS SP-97.
- Brazing outlet can be provided grooved for ring or chamfered for face fed solder.
- Ordering data necessary: Outlet size, type of connection, run size for base.

Pilot and Non-Pilot Bosses

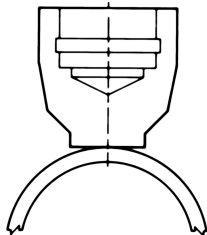

Silver Brazed per
NAVSEA 810-1385912

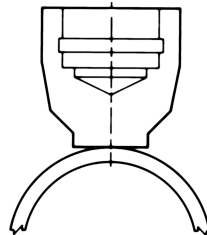

Silver Brazed per
NAVSEA 810-1385950

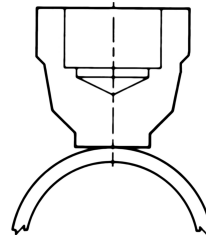

Non-Pilot Boss, Class 400.
Socket Weld

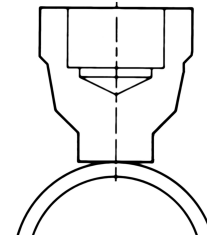

Pilot Boss, Class 400
Socket Weld

- Pilot and non-pilot bosses may be modified for threaded or silver braze.

Miscellaneous Outlets

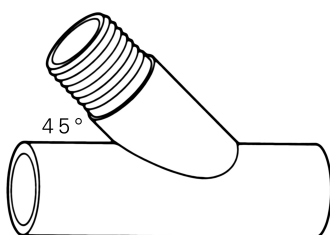

45°

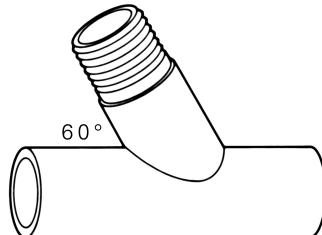

60°

Sanitary Hose Barb Outlets

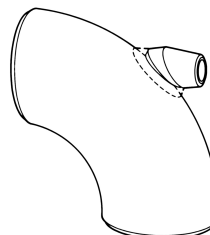

Elbow Outlet

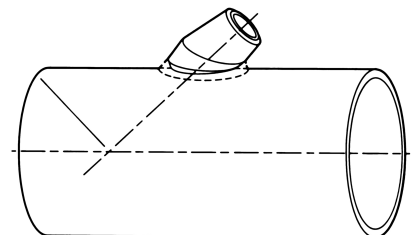

45° Lateral Outlet